

HYDRAULIC & MECHANICAL BRAKE

SERVICE & PARK BRAKE FLOATING MOUNT MEDIUM DUTY

"Rhino"

FEATURES:

- Capable of 1,840 lbs. of service clamp force and 2,460 lbs. of mechanical clamp force.
- Compact size ideal for mounting inside the wheel.
- Tough one piece cast aluminum housing.
- Square seal piston retraction for constant running clearance.
- Removable pad pin design for mounting ease and flexibility.
- Integral park brake manually adjusts for pad wear.
- Quick change pads with long life friction material.
- Integral cable reaction bracket.

TYPICAL SPECIFICATIONS:

Series Medium Duty Hydraulic
 Rotor Diameter 6.0 to 10.0 in.
 Rotor Thickness 0.156 to 0.250 in.
 Lining Type organic or sintered
 Total Lining Area 4 sq. in.
 Usable Lining Thickness Per Pad 0.155 in.
 Weight Approx. 2.75 Lbs.
 Hydraulic Service Brake Information:
 Piston Diameter 1.25 in.
 Maximum Hydraulic Pressure 1500 PSI
 Fluid Displacement @ 1500 PSI 0.025 cu. in.
 @ pad wear out 0.380 cu. in.
 Fluid Type Brake Fluid DOT 3 or 4
 Fluid Inlet M10 x 1.0 Banjo Fitting
 Mechanical Park Brake Information:
 Max Lever Force 200 lbs.
 Max Lever Stroke 40 degrees

Specifications are guidelines only and subject to change. Consult HB for specific model, part number and assembly drawings.

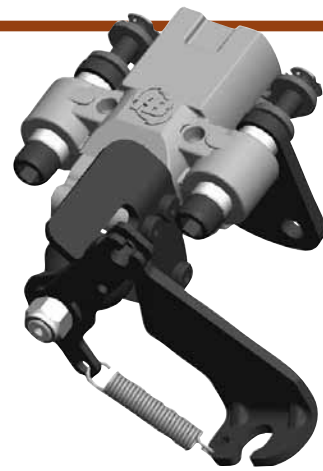

REFERENCE DIMENSIONS:

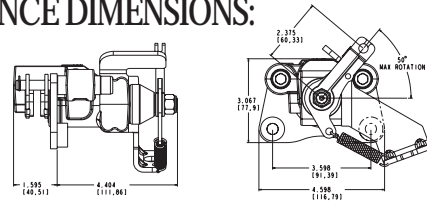

SERVICE BRAKE TORQUE INFORMATION:

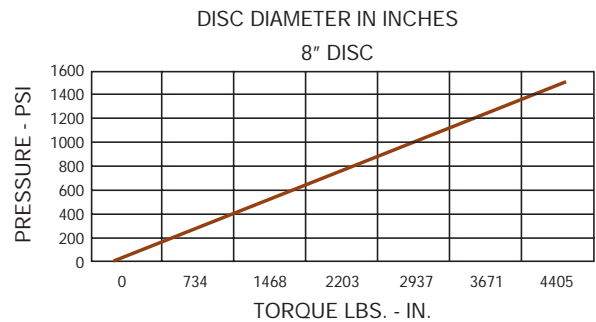

Service Brake Torque Formula: $T = 2.45\mu P \left(\frac{DIA}{2} - 0.575 \right)$

PARK BRAKE TORQUE INFORMATION:

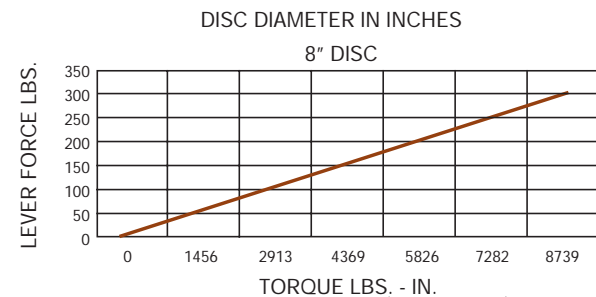

Park Brake Torque Formula: $T = 24.6\mu F \left(\frac{DIA}{2} - 0.575 \right)$

T = developed torque in lbs.-in. DIA = diameter of rotor in inches
 P = applied pressure in psi. μ = friction coefficient, assume 0.35
 F = applied lever force in lbs.



HB Performance Systems Inc.
 5800 West Donges Bay Road
 Mequon, Wisconsin 53092
 Phone (262) 242-4300
 Fax (262) 242-0524
 www.hbpsi.com

Printed in USA